

STANDARD INSTALLATION

TABLE OF ABBREVIATIONS	
AVENUE	AV
BOULEVARDE	BVD
CIRCUIT	CIR
CLOSE	CL
COURT	CT
CRESCENT	CR
DRIVE	DR
ESPLANADE	ESP
LANE	LN
PARADE	PDE
PLACE	PL
ROAD	RD
STREET	ST
TERRACE	TCE

OTHER ABBREVIATIONS TO BE APPROVED BY COUNCIL

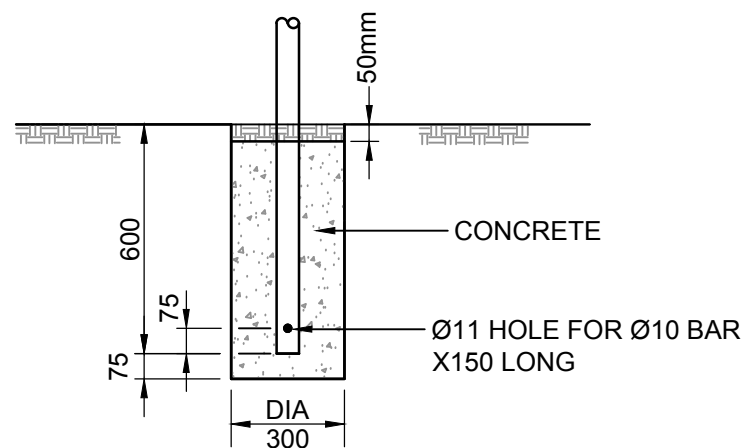

ALTERNATIVE INSTALLATION

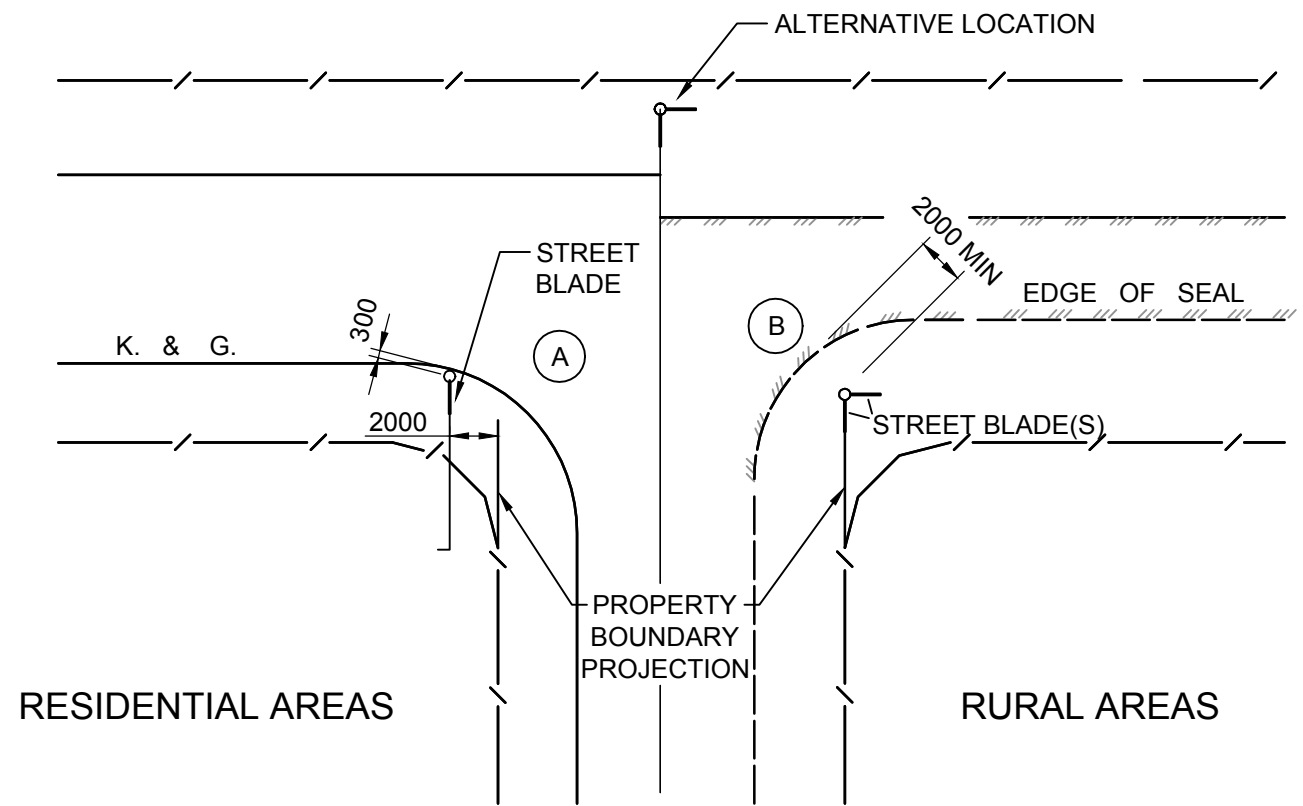

LEGEND

- (A) SIGN POST IS TO BE LOCATED 300mm MIN BEHIND NOMINAL KERB LINE.
- (B) SIGN POST IS TO BE LOCATED 2000mm MIN - 4000mm MAX FROM EDGE OF SEAL, OR AS DIRECTED BY THE SUPERINTENDENT.

NOTES

1. ALL STREET SIGNS TO BE PURCHASED AND INSTALLED BY COUNCIL AT DEVELOPERS COST.
2. STREET NAMES MUST BE APPROVED BY COUNCIL.
3. SIGNS TO BE POSITIONED ON THE SIDE OF STREET AS DETAILED ABOVE.
4. PROPRIETARY DRIVE-IN METAL BASES (OZ POST OR EQUIVALENT) ARE TO BE USED. CONCRETE FOOTINGS TO BE USED ONLY WHERE GROUND IS UNSTABLE.
5. CONCRETE N20 IN ACCORDANCE WITH AS1379 AND AS3600.
6. BARS Ø10, GRADE 250 TO AS1302.
7. ALL DIMENSIONS IN MILLIMETERS.

Armidale <i>Dept of Public Infrastructure</i> Regional Council	SCALES NTS	APPROVED D. MAUNDER MANAGER ENGINEERING AND STANDARDS SUPPORT 10/11/2016 DATE	SHEET 1 OF 1	
		SURV	AS SHEET SIZE A3	DRAWING No 030-075
		DRWN VC		AMDT No
		DES	CHKD MW	CADFILE 030-075.dwg
STREET NAME SIGN				